

POWER D-SUB 21W1 SOLDER CUP-FEMALE

ROHS COMPLIANT

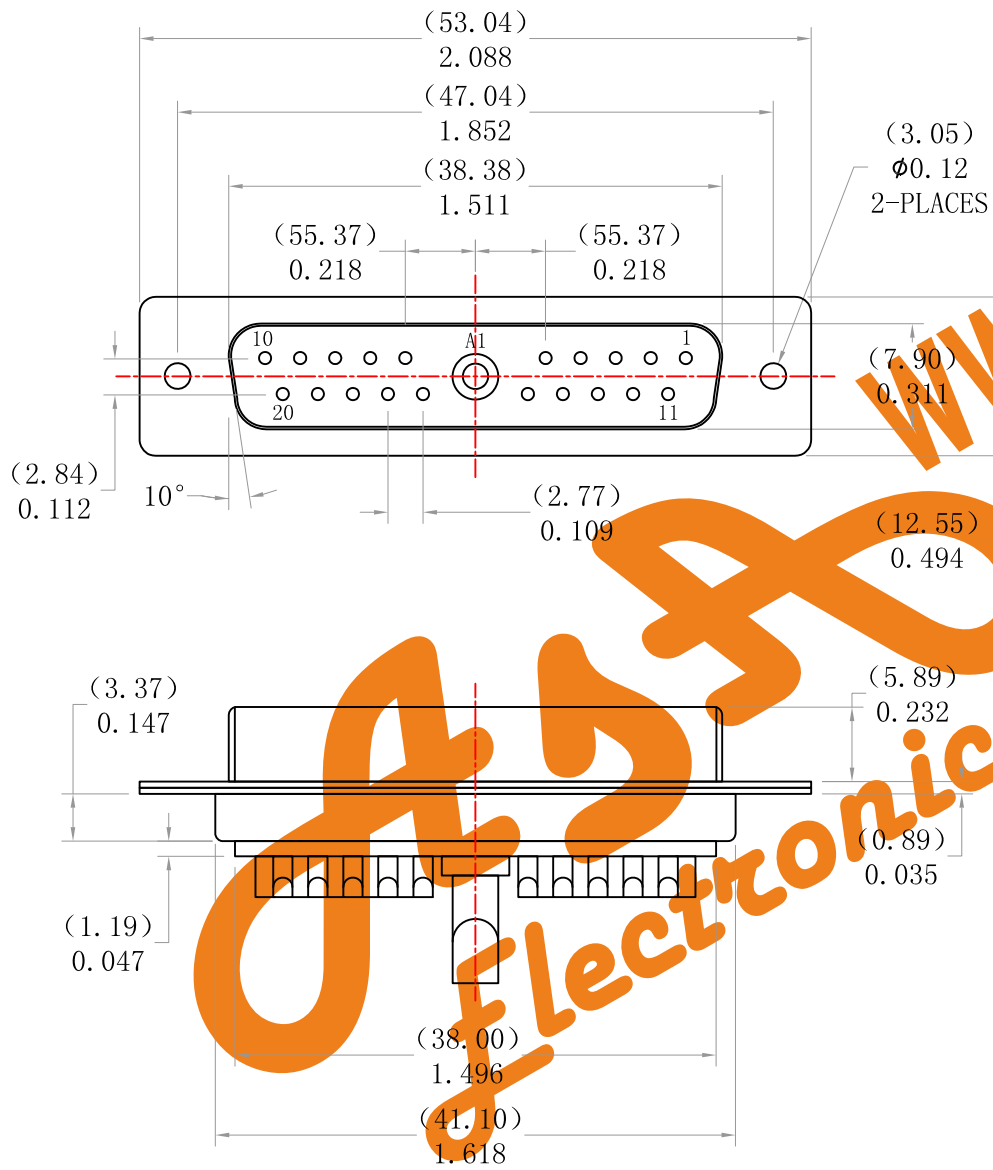

NOTE:
SIGNAL AND POWER CONTACTS
COME PRE-LOADED INTO INSULATORS

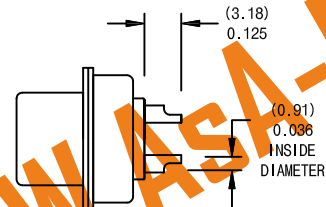

SIGNAL CONTACTS
ACCEPTS UP TO 20 AWG WIRE

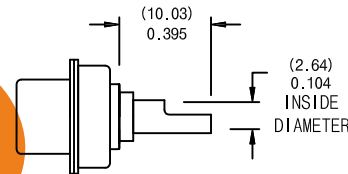

20 AMP POWER CONTACTS
ACCEPTS UP TO 12 AWG WIRE

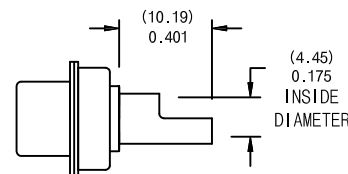

40 AMP POWER CONTACTS
ACCEPTS UP TO 8 AWG WIRE

SPECIFICATIONS:

ELECTRICAL:	
INSULATOR RESISTANCE:	5,000 MegOHMS Min.
DIELECTRIC WITHSTANDING:	1,000 VAC r.m.s.
OPERATING TEMPERATURE:	-55°C ~ +125°C
CONTACT RESISTANCE:	30 MILLIOHMS Max.
POWER PINS:	SEE PART No. BELOW
SIGNAL PINS:	3AMPS
MECHANICAL:	
CONTACT INSERTION FORCE:	4.5kg Max
CONTACT SEPARATOR FORCE:	0.3kg Min
MATERIALS:	
CONTACTS:	BRASS
INSULATOR:	PBT UL94V-0 RATED, 230°C PROCESS TEMP.
SHELL:	STEEL
FINISH:	
SHELL:	NICKEL

Ordering Code:

PDB21W1	-F	-G0	-B	-20	-00
①	②	③	④	⑤	⑥

- ① Series
- ② Contact Type:
M:Male F:Female
- ③ Contact NO. :
G0: Gold flash G1: 3u" Gold
G2: 5u" Gold G3: 10u" Gold
G4: 15u" Gold G5: 30u" Gold
- ④ Insulation Color Code:
B:Black L:Blue
W:White
- ⑤ Power AMP:
10 = 10AMPS; 20 = 20AMPS;
30 = 30AMPS; 40 = 40AMPS;
- ⑥ Series no

Unless Otherwise specified tolerance
X:±0.35
X.X:±0.25
X.XX:±0.20
X.XXX:±0.15



SCALE: 1:1 UNIT: IN (mm)

AsA Electronic Co.
Tel: (+98) 21 66 73 56 82 Mob: (+98) 912 03 161 02

DRAWN: junfon H
CHECKED: YANG

TITLE:
POWER D-SUB 21W1 SOLDER CUP-FEMALE

12/5/3
DATE

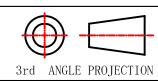

DRAWING NO: PDB21W1-FXXXXX00
PRODUCT NO: PDB21W1-FXXXXX00